



the SVLA BREEZE

YOUR SPRING VALLEY LAKE ASSOCIATION'S OFFICIAL MONTHLY NEWSPAPER FOR THE JEWEL OF THE HIGH DESERT

November 2020

Ads: 760-628-9732

**SVLA LOOKS INTO
PURCHASING THE
COUNTRY CLUB
PG. 4**

**SKATE PARK WORKSHOP
NOVEMBER 21, 2020
MEADOWLARK PARK
PG. 6**

**PLAYFAIR PARK
PLAYGROUND CLOSED
NOV. 10 - DEC. 10, 2020
PG. 12**

INSIDE THE SVLA BREEZE

| | |
|-------------------------------|------------|
| BOD..... | pg 4 |
| GM | pg 6 |
| Before and After..... | pg 7 |
| Concert Collage | pg 9 |
| Code Enforcement | pg 10 |
| Operations..... | pg 12 |
| Virtual Campout Collage | pg 13 |
| Public Safety..... | pg 14 |
| Paint Night Collage | pg 18 |
| Ham Radio Club..... | pg 19 |
| Our Spring Valley Lake..... | pg 20 |
| Yacht Club | pg 23 & 24 |
| Community Events | pg 28 |

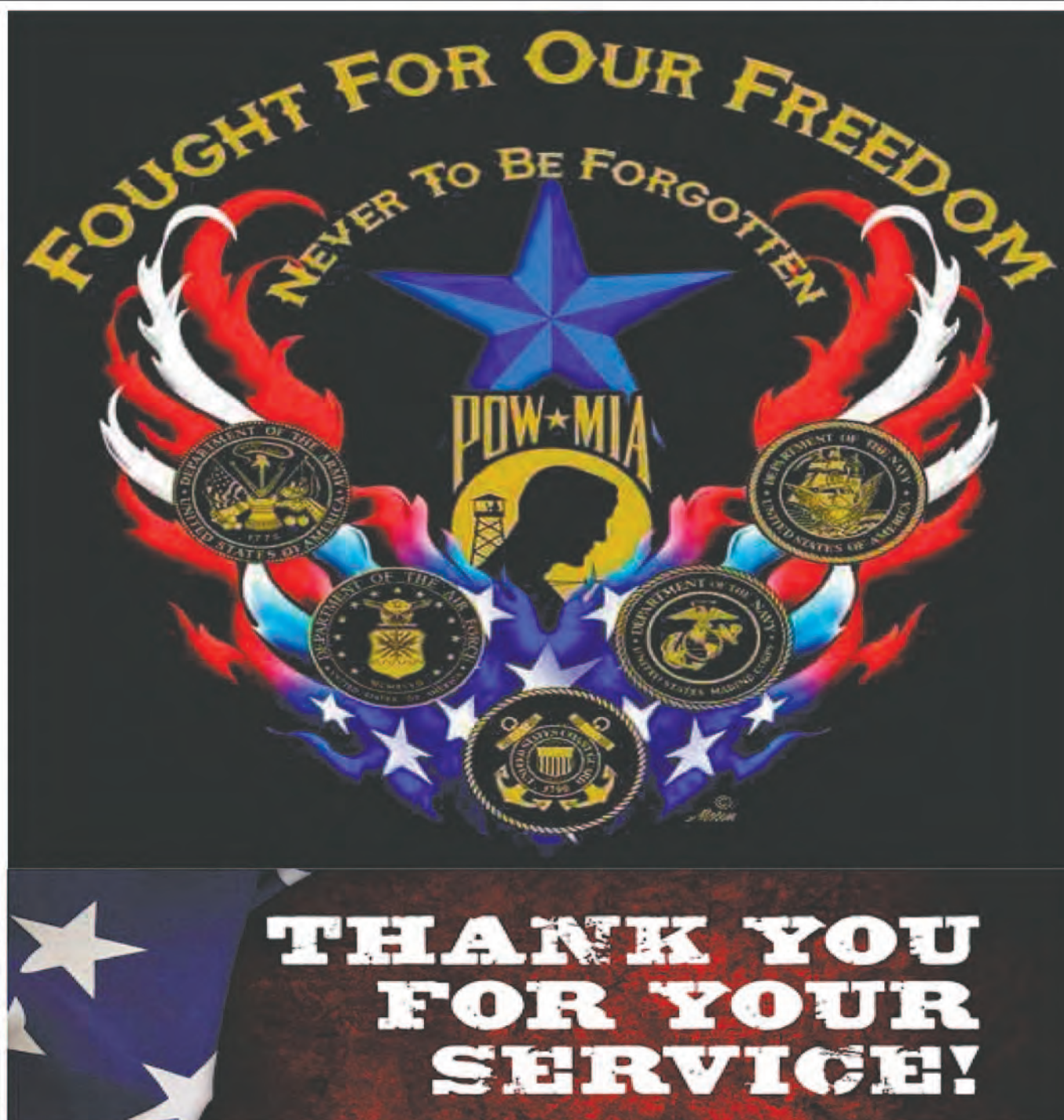



Spring Valley Lake Contact Information

Management Staff

General Manager

Alfred Logan: alogan@svla.com

Director Public Safety

Lisa Falcetti: lfalcetti@svla.com

Director of Operations

Nick Gonzalez: ngonzalez@svla.com

Director Administration & Human Resources

Jeanne Beam: jbeam@svla.com

Accounts Manager

Dee Dee Walker: dwalker@svla.com

Board of Directors

President Brian Bickhart

Vice President JoAnne Romero

Secretary Lewis Ponce

Treasurer Brian Hurst

Director Cheri Boyd

Director Robert Read

Director Bill Scott

Board Email: board@svla.com



SVLA Breeze
PO BOX 1079
Helendale, CA
92342

Publisher
Love Media Group

Published
monthly at:
Silver Lakes
PO Box 1079
Helendale, CA
92342

Advertising:
JR Love
760-628-9732
Advertising Email
contact:
LoveMediaGroup
@yahoo.com

The acceptance of an ad in the SVLA Breeze does not constitute approval of SVLA Breeze or Spring Valley Lake Association, but it is solely the view of the advertisers. Letters to the Editor and articles submitted by Spring Valley Lake residents do not necessarily reflect the opinion or the endorsement of the publishers of SVLA Breeze or Spring Valley Lake Association but rather are the responsibility and opinions of the authors of those articles. SVLA Breeze will always try to give equal time to those who submit to us articles or letters with a differing opinion than the articles featured in this paper. Any ad placed with Love Media must contain a sponsor, a product or announcement. The exception to the rule would be a person running for political office. Ads of complaints against the Association or any business, or personal attack ads will not be accepted.

SVLA Administration Office
13325 Spring Valley Parkway
Spring Valley Lake, CA
92395-5107

Mailing Address:
7001 SVL Box
Spring Valley Lake, CA
92395-5107

Association Office:
760-245-9756

Fax Line:
760-245-3076

Website:
www.svla.com



Association office hours:
Tuesday – Friday
7:30 a.m. to 6:00 p.m.

Public Safety:
12975 Rolling Ridge Drive
Spring Valley Lake, CA 92395
Open 24/7/365
Direct Line: 760-245-6400

Additional Services:
Architectural/Code
Enforcement:
760-245-9756
CE@svla.com

Marina Hours:
(October - April)
6 a.m. – 10 p.m.
(May – September)
6 a.m. – 12 Midnight

Equestrian Center:
760-245-9756
12660 Indian River Drive
Apple Valley, CA 92308
Arena Hours: 8 a.m. - 10 p.m.

In Case of Emergency dial:
911

Emergency Contact #s:
SB County Animal Control:
800-472-5609
A.V. - 760-240-7000 x7555

Apple Valley Fire Protection
District (Equestrian Estates):
760-240-7618

Apple Valley Sheriff Station
(Equestrian Estates):
760-240-7400

SVL Fire Station (Lakeside):
760-245-1100

California Highway Patrol:
760-255-8750

San Bernardino County
Sheriff's Department:
760-245-4211

Numbers FYI:
County Code Enforcement
Violations pertaining to County
rules and regs:
760-995-8140

County Building and Safety
New housing construction, struc-
tures built on property:
760-995-8220

(SBC) Planning Dept.
760.995.8140
Town of Apple Valley
(EQ side only): 760-240-7000

Department of Public Works
Water / flood control
760-995-8220

Graffiti Removal:
SB County: 760.995.8140
Apple Valley: 760-240-7000
x7560

San Bernardino County
Environmental Health Services
(Vector Control)
800-442-2283



The SVLA Breeze has incorporated QR Codes into our newspaper. A QR (“Quick Response”) Code is a mobile phone readable barcode. Simply point a mobile phone (or other camera-enabled mobile) at it. If the device has had QR Code decoding software installed on it, it will bring up its browser and go straight to that URL. QR Code Reading Apps are available from your Smartphone App Store.

Email Inquiries, Articles, Editorials for The SVLA Breeze to: info@svla.com

LYON'S

FLOOR COVERING & BLINDS

Family Owned & Operated

*Serving the High Desert and
surrounding areas.*

*Our experienced team
provides installation
of quality:*

- carpet
- tile
- granite
- hardwood
- laminate
- waterproof flooring.

*We also provide bathroom &
kitchen remodeling.*



VICTORVILLE

15922 BEAR VALLEY RD

M-F 9AM-5PM

SAT 10AM-3PM

BARSTOW

427 E. MAIN ST

M-F 10AM-4PM

SAT 10AM-2PM

SPECIAL OFFERS

STOCK PORCELAIN TILE

12/24 or 20/20 \$.73 /ft

SHAW BELLERA CARPET

10 year free replacement ~ beautiful colors
See store or website for details

MOHAWK SILK CARPET

Softest carpet there is!
Great warranty ~ always on sale
Hundreds of yards of carpet in stock

CARPET SPECIAL

100 yards of carpet installed for \$1350!
Limited to supply on hand
See store for colors and quality

WATERPROOF FLOORING

Great products starting at \$5.50/ft installed

TILE INSTALLED

Starting at \$4.50/ft ~ See store for details

LAMINATE FLOORING

Installed \$3.50/ft ~ several colors to choose from

70 oz CARPET FROM SHAW

\$3.00/ft installed with moisture barrier pad

**Call our team today at 760-949-8001 when you're ready to make a
change in your home or office.**



SVLA BOARD PRESIDENT

BRIAN BICKHART

As most of you are aware, Spring Valley Lake Association is looking into the option of purchasing Spring Valley Lake Country Club. With this being a large asset to the community, one of which would impact the property owners of our community greatly, we wanted to do our due diligence by hiring a consultant to guide us through this process.

Spring Valley Lake Association has hired Christovich and Associates to give their professional opinion of this project. Christovich and Associates is a full-service Consulting, Management, Advisory and Brokerage service company based in Melbourne Beach, Florida.

Over the last 10 years Christovich and Associates has been involved in the management, consultation, operational assessment and acquisition/disposition of more than 100 golf assets across the country. Christovich and Associates is one of the only golf course brokerage firms with an extensive background in full-service golf and country club management and operations. Due to their extensive background, this allows them to have a unique capability of knowing how to look at a golf course and country club from all sides of

the equation including market dynamics, physical conditions, financial performance, human resources and asset value. In addition to Christovich & Associates vast knowledge of golf courses and country clubs, they are very familiar with the inner workings of Clubcorp, both at a club and corporate level. Since Clubcorp is the current owner of the Spring Valley Lake Country Club, this will greatly benefit the Association in this process.

Greg Christovich, is nationally recognized in the golf course industry as one of the leaders in club management, brokerage, and distressed golf operations advisory skills and experience. Greg began his career in the corporate restaurant industry, spent ten years as a General Manager in private equity clubs, and was a regional vice-president and chief operating officer for three of the largest golf management companies in the U.S.

Christovich and Associates are unique in the industry in that they are very selective in the assignments they take on. They are very committed to a hands-on approach; therefore, they do not take on any more than six projects at a time. So we can rest assured that our project will have

their full attention.

The scope of work that Christovich and Associates will be doing for Spring Valley Lake Association is outlined below:

Christovich and Associates will be researching the facilities and operations of the Spring Valley Lake Country Club to gain an independent perspective of facility conditions and guest service experiences. They will be looking into the Capital Improvements and compile a list of needed and or desired capital improvements present at the club. They will be looking into the Organizational Structure and Personnel of the club to gain a better understanding of what they do and what some of their key challenges are in the day to day operations. They will be reviewing membership feedback, past and present, gauging guest satisfaction and assessing the overall value perception for the club operation. They will conduct a thorough financial evaluation of all areas of the club as well as prepare a comprehensive market analysis for the club, benchmarking membership fees, rates,

course conditions, amenities and other relevant information. This will also include a comparison to other similar facilities in the market.

Once they have completed their overall assessment of the facility, they will prepare a high-level projection of revenues, expenses and capital improvements for the operation of the club. Upon their final evaluation, they will prepare a Broker Opinion of Value including a hypothetical purchase (financial) scenario and task list/timeline under the assumption that the Association purchases the club amenities.

We are confident that by hiring Christovich and Associates it will allow Spring Valley Lake Association to have a better understanding of the full workings of the club and make an educated decision on the purchasing of Spring Valley Lake Country Club.

If you would like to know more information about Christovich and Associates, as well as view their principles, visit their website www.christovichandassociates.com.





**WE ARE
OPEN**

760-684-4521

Let us Sanitize Your Home for you!

**Gift
Certificates
Available**



Save \$100

**\$50 OFF Your First Initial Clean &
\$10 OFF Your Next Five Regularly
Scheduled Cleans**

OR

Save \$25

**When You Invite Molly Maid In
For A One-Time Clean**

**New customers only. Offers valid one time
per household.**

760-684-4521

*"All of our professional cleaners are
outfitted with masks, gloves and foot
covers ~ which they replace for each and
every job. Your safety is paramount to us!"*



MOLLY MAID

a neighborly company

Visit us at MollyMaid.com to learn more.

2018 Molly Maid, LLC. Each franchise is independently owned and operated.

Exciting and New!

**Dr. Shima Hadidchi MD in partnership with
Becky Jordan and Justin Atkins**

12740 Hesperia Rd

760-998-1999

**Reduction of Acne, Fine Lines and Wrinkles, Scars, Stretch
Marks and promotes Skin Tightening!**



Dr. Shima Hadidchi MD

Top family physician 2020 in state of
California, Board certified Family
practice Specializing in Telehealth,
Geriatrics, women health, weight loss
management, Diabetes, Asthma,
Dermatology and more. She is accepting
new patients. **Please call 760-998-1999**



Justin Atkins Nurse Practitioner,
Board Certified in Adult-
Gerontology Acute Care

Skin Specialist in:
Permanent Makeup
Micro Needling Technology
Tattoo Removal



Becky Jordan is a 30 year resident of the High Desert and
has been a licensed aesthetician in California for 30 years
and in Nevada for 10 years. She has received extensive
training and has been recognized for her work with cancer
survivors and was named by the Victorville Desert Dispatch
as a Woman of the Year. **Call 760-954-0976.**



information on our website at **www.SVLA.com**. We look forward to improving and increasing the communication with our community.

Facebook:

Percentage increase since
November 1, 2019 **46.81%**

Instagram

Percentage increase since
November 1, 2019 **55.79%**

Constant Contact:

Percentage increase since
November 1, 2019 **54.89%**

**PHONE**

E MAIL

E MAIL

MAILING ADDRESS

S Please verify that the contact information we have on file for you is still correct and up to date, as well as any emergency contact we have or you would like to add.

Send us an email: Admin@svla.com
Call us: 760.245.9756
Fax: 760.245.3076



November 21, 2020



**We are inviting the
Community out for a
Skate Park Workshop
led by Spohn Ranch
Skate Parks.**

Spohn Ranch is a skate park designer . We would love for our community to be involved in the vision of the proposed skate park. Hope to see you there!



BEFORE AFTER



UNITED BOOKKEEPING GROUP

| | |
|-----------------|-----------------|
| Sole Proprietor | \$80 per month |
| Partnership | \$100 per month |
| Corporation | \$120 per month |

Time is money ~ save time & money!

MONTHLY:

- Financial Statements
- Percentage Business Analysis
 - Balance Sheet
 - Sales Tax Reports
- All Necessary Reports

YEARLY at an additional fee:

- Federal Income Tax
- Federal Unemployment
- California Unemployment
- California Income Tax
 - 1099 as needed

**ALL MONTHLY WORK IS COMPLETED
WITHIN 5-7 WORKING DAYS**

~We pick up and deliver~

CALL (760) 780-3353



~Valysia Shogunle, Code Enforcement Supervisor

Thank You!

The Code enforcement department who made corrections promptly would like to say thank you to all when notified. Here are just a few the owners who have maintained their properties so well and those properties who passed their annual inspection with flying colors

| Code Enforcement Violations | OCT Stats |
|------------------------------|-----------|
| IN PROGRESS | 185 |
| OPENED | 645 |
| CITATIONS | 66 |
| CLOSED - (Resident complied) | 910 |
| DOOR TAGS (Courtesy Notices) | 130 |
| OPEN ESCROWS | 44 |

| Rental Rule - OCT | Stats |
|-------------------------|-------|
| Open violations | 76 |
| Dwelling license | 4 |
| Res. Rule Violation | 1 |
| Total confirmed rentals | 375 |



FOR YOUR LASIK NEEDS.

NVISION

EYE CENTERS

THE EYE DOCTORS' #1 CHOICE

WHY CHOOSE NVISION?

- Ask Me About Your Employee Discount
- Free No Obligation Consultations
- Special Financing Available
- World Class Surgeons
- Latest in Advanced Technology
- Convenient Locations
- Lifetime Commitments Available
- Gold Standard Patient Care

WANT TO LEARN MORE?

Contact Mike Bossard, Territory Manager
760-713-3577 • Mike.Bossard@NVISIONcenters.com

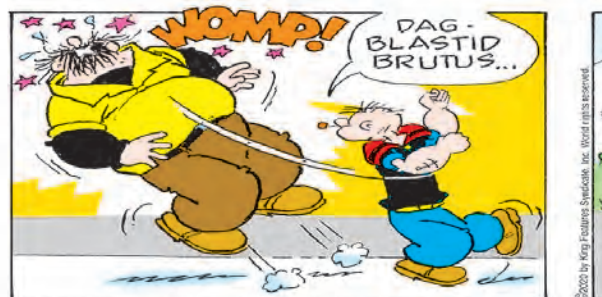
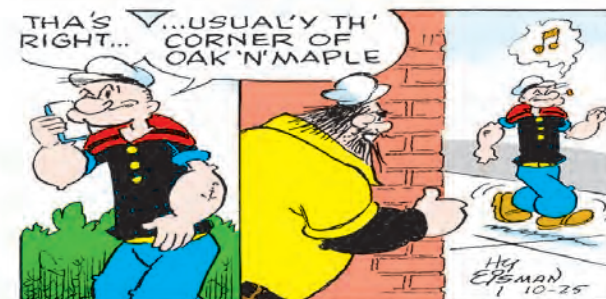
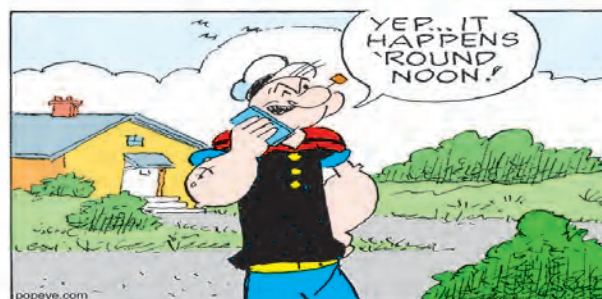
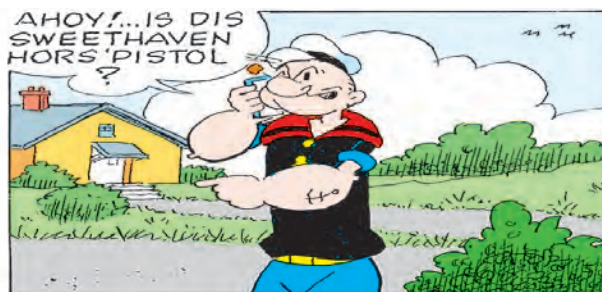
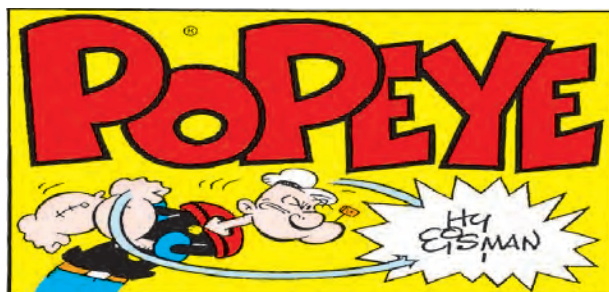



~ Nick Gonzalez, Director of Operations

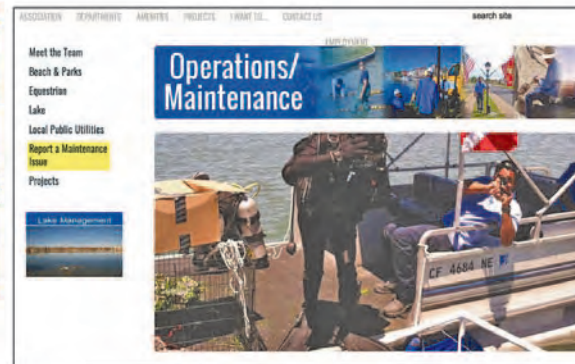

If you would like to report a maintenance issue, please visit our website at www.svla.com. Click on the **Department** tab and pull down to **Operations/Maintenance**.

Playfair Park Closed November 10- December 10, 2020



Please be aware that Playfair Park, in the Equestrian Estates, will be closed from **November 10, 2020 through December 10, 2020** for the preparation and installation of new playground equipment.

During this time the grassy area will remain open but the entire playground area will not be accessible.

We thank you for your understanding and we look forward to seeing the area updated.





HALLOWEEN VIRTUAL CAMP OUT

WE HAD 58 FAMILIES SIGN UP FOR OUR VIRTUAL HALLOWEEN CAMP OUT... EVERYONE WHO REGISTERED RECEIVED A CAMP OUT KIT FILLED WITH FUN GAMES, ACTIVITIES AND CRAFTS TO COMPLETE AT HOME. THE BASKETS CONSISTED OF S'MORE KITS, PUZZLES, CRAFTS, CAMP FIRE GAMES AND MORE. WE LOVED SEEING EVERYONE'S PHOTOS COME IN OVER THE WEEKEND. WE HOPE YOU ALL ENJOYED YOURSELVES!!

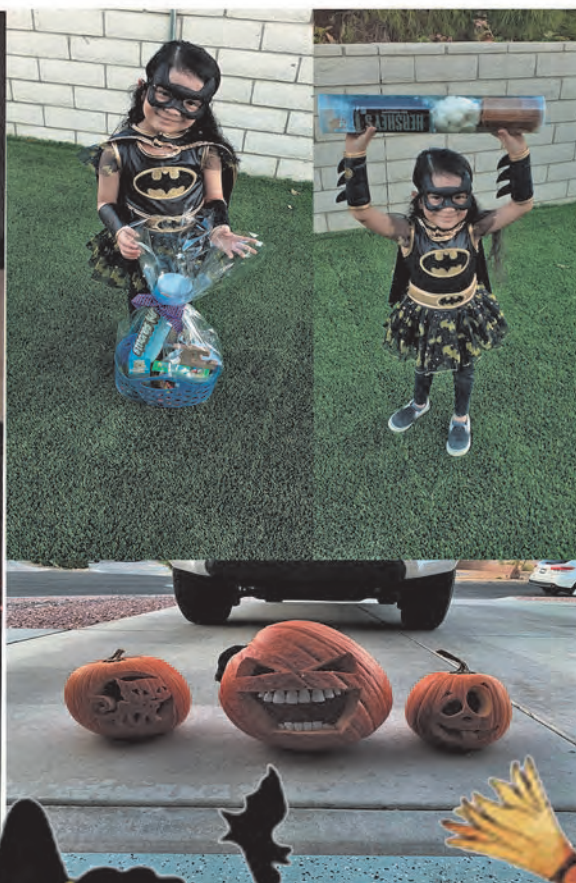



LISA FALCETTI, PUBLIC SAFETY DIRECTOR



The holiday season is quickly approaching and this year, due to Covid, there will be a larger increase in the number of residents who are buying gifts online and having them delivered to their homes. Unfortunately, this means that thieves now have ample opportunity to steal your packages that have been left out. To try and deter this behavior, it is essential to take precautionary steps to ensure your property is safe. If you have ordered a package and it is being delivered while you are away from home, try to contact the delivery company and request to pick it up at an authorized facility; or if possible, have it delivered on a different date. If the delivery company cannot accommodate your request, try asking a neighbor, a friend, or a family member to pick up the package for you once it is delivered to your front door. If you have exhausted all other options, but you still need assistance, call the Public Safety Department at (760-245-6400). As an extra service, our staff can provide assis-

tance by moving your package to a discrete location on your property. A Public Safety Officer will attempt to better conceal your package from the general view of the public and, as a last resort, the officer will bring the package to the Community Building where it can be picked up by the owner. Please keep in mind that this option is an absolute last resort as the Public Safety Department does not have the room to hold your packages for more than 24 hours. It is also important to note that if the package size is too large for a Public Safety Officer to move safely, we will be unable to accommodate your request. If you are having us hold a package for you, know that you will be required to show your picture ID to retrieve it and it will only be released to the individual that the package is addressed to. This is a special courtesy that the Association is only providing during the holiday season and we will not be responsible for any damages that might occur. 💎



Spring Valley Lake Association is advising all residents of current California laws that they must comply with in order to enjoy boating anywhere in California.



COMPLIANCE WITH

California State Law



SVLA will require all those registering a vessel here in Spring Valley Lake for the **2022 Stickers** to already have their California Boater Card. (Please see below for age requirements)

By the year 2025, everyone regardless of age will be required to carry a California Boater Card while operating a powered vessel on all California waterways. This includes our lake. If you have not yet received a California Boater Card, it is essential that you begin the process as soon as possible to be in compliance with state law.

For more information visit:

CaliforniaBoaterCard.com

or call California Division of Boating & Waterways at

(844)-421-8333

AGE REQUIREMENTS

| | |
|------|----------------------------|
| 2020 | 35 YEARS AND YOUNGER |
| 2021 | 40 YEARS AND YOUNGER |
| 2022 | 45 YEARS AND YOUNGER |
| 2023 | 50 YEARS AND YOUNGER |
| 2024 | 55 YEARS AND YOUNGER |
| 2025 | EVERYONE REGARDLESS OF AGE |



**FOR IMMEDIATE
RELEASE
October 14, 2020**

***BCC Wins National Honor with
The Trade Technician Jump Start
Program***

***BCC gets “Workforce Ready” with
innovative programming***

Barstow, CA --Barstow Community College (BCC) was declared a national winner in the 2nd annual NACCE 2020 Pitch for the Trades competition sponsored by the Philip E. & Carole R. Ratcliffe Foundation. With a goal of empowering job creation and entrepreneurs in the local region, BCC competed in the National Association for Community College Entrepreneurship nation-wide contest with the newly created and innovative Trade Technician Jump Start Project.

The Trade Technician Jump Start Certificate Program is a non-credit, no cost, hands-on experience course designed to teach students the basic principles and core skills in 8 high-demand trades that touch nearly every industry and business in our local community. The program, designed to engage high school students, adults, high risk youth, unemployed, veterans, homeless and those seeking retraining opportunities will experience learning that includes OSHA safety standards, hand and power tools, construction basics and drawings, welding, plumbing, electrical, HVAC and customer service. Students can enter the workforce immediately by applying for entry-level, living wage jobs in any business sector. The program also includes an entrepreneurship component for those that are interested in starting a business of their own.

Upon completion of the no-cost program, students will have the opportunity to apply for employment through BCC’s job placement program or participate in paid internship programs with industry partners, including PG&E who helped champion the formation of the Jump Start Program. A winning strategy for this program was the collaboration with regional employers in finding internships or gainful employment for student completers.

The winning BCC team led by Dr. Crystal Nasio, Dean of Instruction, Economic and Workforce development, competed in three-rounds of “pitches” to get to the finals. Team members include faculty from the career and technical education area--Toby Hill, Josh O’Neal, Roland O’Neal, Denise Pasley and included PG&E, Senior Technical Project Manager, Jessica Bails.

BCC was one of 5 community colleges in the nation to receive this prestigious honor. Other winning colleges include the City College of San Francisco (California); Catawba Valley Community College (North Carolina); Washtenaw Community College (Michigan); and North Idaho College (Idaho)

“We are extremely proud of our BCC faculty and staff for competing on a national level and for working with our local business partners to deeply understand the skills and knowledge that are necessary for their entry-level employees and for career advancement of their existing employees. We are also incredibly grateful to the National Association of Community College Entrepreneurship and the Ratcliffe Foundation for sponsoring this competition which helped us to

refine how we communicate the value of our program and to learn about other innovative community college programs across the country. Barstow Community College is proud to be a recognized leader nationally and in the economic development of our region.” Dr. Eva Bagg, Barstow Community College, Superintendent-President.

BCC is quickly becoming known as a regional leader in innovation and entrepreneurial efforts. In fall 2019, the college was chosen to sponsor an entrepreneurial workshop series in collaboration with the Small Business Development Center of Orange County and Inland Empire. In August, BCC was awarded the coveted Growing Inland Achievement Innovation award, for a project that cultivates creative confidence and the entrepreneurial mindset for students in middle school and will be part of the college’s growing outreach efforts. The college has also become a leading partner in establishing and growing an Innovation and Entrepreneurship ecosystem that engages regional California community colleges, state and

private universities, government and military partners, local and regional business leaders, innovators, entrepreneurs, and non-profit organizations to spur regional economic development and to collaboratively solve real-life challenges within our Inland Empire communities.

Even during the pandemic, Barstow Community College is encouraging students and prospective students to Stay Connected and Move Forward with their education. The nationally recognized, no-cost Trade Technician Jump Start Program may be the first step to your new future.

To learn more about enrolling at the college, the Trade Technician Jump Start Program at Barstow Community College, NACCE, the Ratcliffe Foundation, or industry partnerships, please contact CTE at: cte@barstow.edu or (760) 252-6799

Media Contact:
Director of Public Relations,
Communications, and Marketing
AMANDA SIMPSON
asimpson@barstow.edu



(Top Row, L-R; C. Nasio, D. Pasley, T. Hill, E. Bagg) (Bottom Row, L-R; J. O’Neal, R. O’Neal, J.Bails)



SERVING OVER 3000
HOMES IN JESS RANCH
AND SPRING VALLEY
LAKE

VOTED THE BEST

3 YEARS IN A ROW!

CARPET, UPHOLSTERY AND TILE & GROUT CLEANING

Celebrating our
31st Year!

Serving Christ In All
We Do.



**MORE 5 STAR YELPS THAN
ANY OTHER CARPET CLEANER**



760.951.0055

www.gregscarpetcleaning.com



ARE YOU TIRED OF WAITING TO SEE YOUR PROVIDER?

Call Desert Valley Medical Group to schedule an appointment. **Same day appointments available.**



Got Medicare?

CALL NOW TO SCHEDULE A **FREE** IN PERSON HEALTH ASSESSMENT WITH ONE OF OUR PROVIDERS

Call Member Services to schedule your appointment or for more information:

760-615-3511

EXTENDED HOURS:

Monday - Saturday



Three convenient locations to serve you.



Desert Valley Hospital
Desert Valley Medical Group

Member of Prime Healthcare



PAIN T NIGHT



WE HAD A GREAT TURN OUT FOR OUR PAINT NIGHT ON OCTOBER 9, 2020. WE CAME IN WITH 81 RESERVATIONS AND EVERYONE CAME FOR A GOOD TIME. WE ARE THANKFUL TO BLANK CANVAS PAINT NITE IN HESPERIA FOR COMING OUT AND HOSTING THE EVENT FOR US. THEY DID A FANTASTIC JOB. ALL WHO PARTICIPATED HAD A GREAT TIME AND THERE WERE SOME GREAT MASTERPIECES CREATED. WE HOPE TO SEE YOU ALL NEXT TIME.





SPRING VALLEY LAKE **KK6 AMATEUR RADIO CLUB **SVL****

MEETS 1ST THURSDAY OF EVERY MONTH

**7:00 PM
PALM ROOM
12975 ROLLING RIDGE DR.**

**If you have a HAM License
Want to Test for a HAM License
or are interested in learning
more about HAM Radio**

JOIN US AT THE MEETING



**CONTACT
GEORGE ELLISON
760.810.1008**

WWW.SVLARC.ORG

Our Spring Valley Lake - The Building Begins

by Jeri Lawrence

On October 20, 1969, the Boise Cascade property sales office as well as the accompanying buildings were completed and officially opened. The entrances to the new development are planned, and the actual plot design is completed. The original drawing shown here is the same "blue map" in use today. These plans include the (potential) country club and golf course. On the original plans, an elementary school was planned where Meadowlark Park is (instead) today. The project was built on the Kalin Cattle Ranch that stretched from

Bear Valley Road to close to the Mojave River Narrows, and eastward to Apple Valley Rd. At the same time, The Sage Hen Ranch, a retreat that had been in place since 1936, was still very active within the sphere of the Spring Valley Lake project. It is said that famous people retreated there to get away from the everyday hustle and bustle of their lives. According to the CC&R's, the annexation of the land where the Sage Hen Ranch stood, was signed and completed in January 1991.

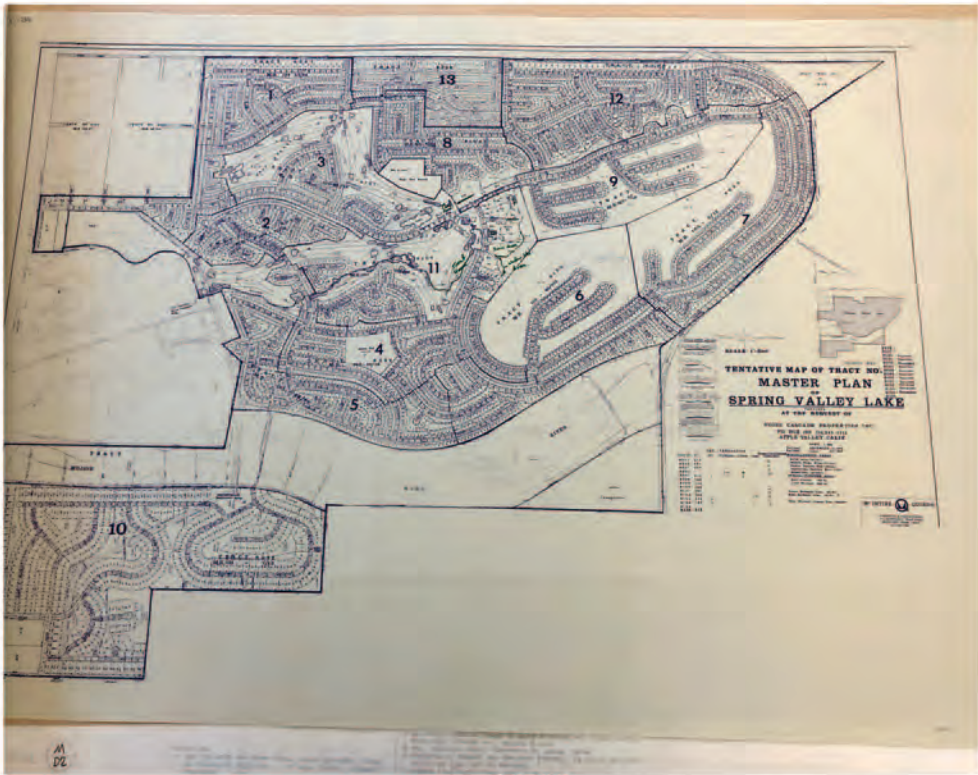

(Original Master Plan Drawing)

(First home built on Sage Hen Road)

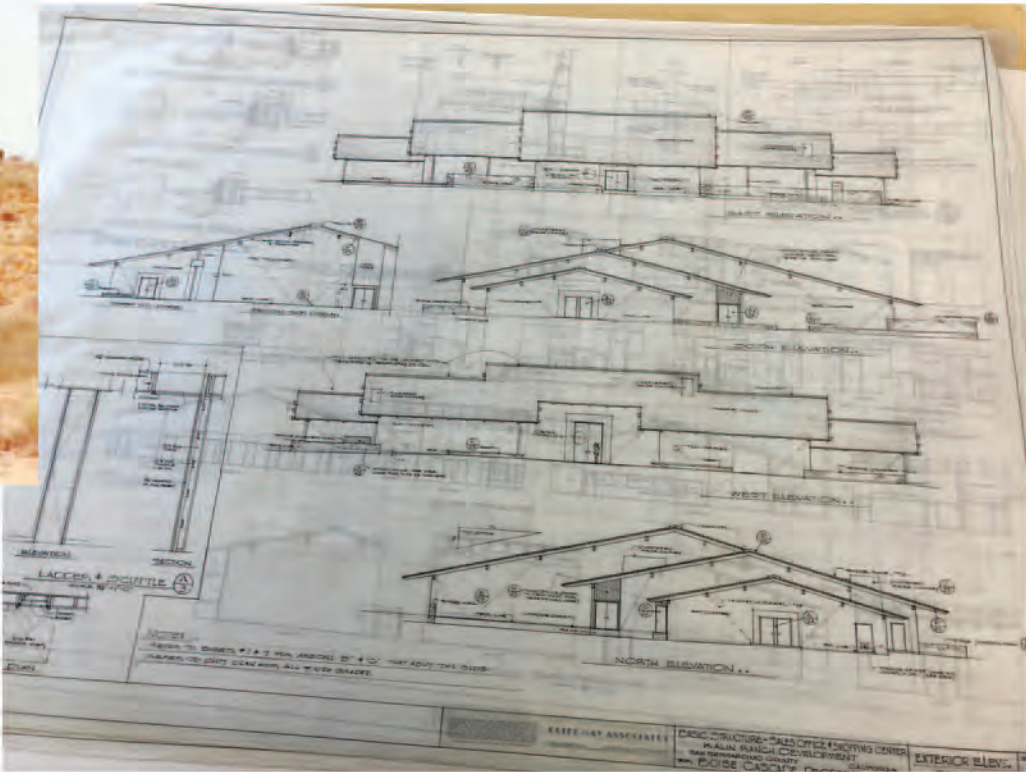

(The first drawings of the Country Club)

Construction of the SVL Country Club began in June of 1970, designed by Cliff May, and was completed on June 28, 1971. Boise Cascade held ownership of the club and golf course until May 1975 when C.C.A. purchased the operation.

The History of Spring Valley Lake written by Archie A. "Scotty" Lauchlan. His writing details the people who were prominent in building our community. The photos included in his writings are priceless.

I would invite you to download

DAVE'S MOBILE MARINE REPAIR

Dave Mazzaresse
Owner
mazz75@msn.com



WWW.DAVESMOBILEMARINEREPAIR.COM
Apple Valley, CA 92307 | 760.987.0846
BUSINESS LIC #009439 - INSURED

New to Our *Community*



Ruby Jhaj, M.D.
Internal Medicine
18522 Highway 18, Suite 208
Apple Valley, CA 92307
(760) 242-9262



Anitha Bhat, M.D.
Geriatrics/Internal Medicine
19015 Town Center Dr #101
Apple Valley, CA 92308
(760) 247-0581



Mitesh Patel, M.D.
General Surgery
13010 Hesperia Rd #400
Victorville, CA 92395
(760) 242-9355



Nyra Khetarpal, M.D.
Internal Medicine
18522 Highway 18, Suite 208
Apple Valley, CA 92307
(760) 242-9262

Now Accepting New Patients

✓ Same Day Appointments Available ✓ Se Habla Español

19111 Town Center Drive, Apple Valley, CA 92308 | 760-242-7777 | ChoiceMG.com





Smile Makers
JOSEPH E. EISWERT, DMD

Dr. Joseph E. Eiswert D.M.D.
Temple University Graduate,
USAF Captain
Family Dentistry



Family Dentistry, Implants & Orthodontics



Each one of our patients is unique... with unique needs and concerns. We offer all of the services you would expect and need from a competent dental office. If you have any questions about any of the services below, please give us a call.

- PREVENTATIVE CARE
- DIGITAL X-RAYS
- COSMETIC DENTISTRY
- MINI DENTAL IMPLANTS
- LUMINEERS ®
- PORCELAIN VENEERS
- DENTAL CROWNS/BRIDGES
- ZOOM TEETH WHITENING
- COSMETIC DENTISTRY
- INVISIBLE BRACES BY INVISALIGN +
CLEAR CORRECT
- ENDODONTICS/ROOT CANAL
- VIZILITE PLUS ®
- RESTORATIVE DENTISTRY

- REPLACEMENT FILLINGS
- ORTHODONTICS
- IMPLANTS
- CHILDREN AND INFANT CARE
- SEALANTS
- PRIMARY TMJ TREATMENT
- FILLINGS, ROOT CANALS
- SPORTS DENTISTRY
- PERIODONTAL/GUM
DISEASE
- SMILE ENHANCEMENT
- ORAL SURGERY
- DENTURES/PARTIALS
- EXTRACTIONS/WISDOM TEETH
- TRAUMA
- PLAYSAFE ®
- MOUTH GUARDS
- BONE GRAFTS



Financing Available
Most Insurance Accepted
Always Accepting
New Patients

Silver Lakes
27170 Lakeview Dr., Ste 203
Helendale, CA
245-5704

Apple Valley
19063 Hwy 18, Suite 102
Apple Valley, CA
242-7800

After Hours Emergency, Contact Dr. Eiswert via mobile # 760-954-7012



Holiday Lighted Boat Parade

SUNDAY NOVEMBER 29, 2020

MEET AT EAST BEACH



**SANTA CLAUS WILL BE PRESENT
AT 4:30 P.M. FOR PICTURES.**

**JUDGING OF BOATS WILL BE
5:00 P.M. — 5:30 P.M.**

**WINNER RECEIVES \$200 CASH
PARADE STARTS AT 6PM**

**INFORMATION CONTACT:
RICK GROFF 442-242-7095
OR TEXT 518-879-9668**

ArchAngel

ESTATE PLANNING AND TRUST SERVICES

- . Avoid Probate
- . Pass Wealth Efficiently
- . Minimize Taxes and Fees
- . Minimize Conflict Between Beneficiaries
- . Coordinate your plan with your Advisors
- . Guidance Administering a Living Trust
- . Living Trusts and Trust Amendments
- . Wills
- . Health Care Directives
- . Durable Powers of Attorney
- . Probates
- . Guardianships and Conservatorships

**Call (760) 946-2233 for your consultation
with our experienced, caring attorneys.**

www.archangeltrust.com ~ 16191 Kamana Road, Apple Valley, CA 92307

Victoria Martin is an active member of the State Bar, licensed to practice law in California. CA Bar # 277116.



The Spring Valley Lake Yacht Club will be hosting our

2nd annual Holiday Outdoor Decoration Contest

Judging will include both SVL Lakeside and at the Equestrian Estates. Judging will be the weekend of December 19 - 20, 2020. Prizes will be a Lowe's gift card:

First Prize - \$300

Second Prize - \$200

Third Prize - \$100



Entry is simple. Decorate your house and send us your street address via text to 518-879-9668, email: rickat51@aol.com, or call Commodore Rick Groff at 442-242-7095. Also, watch for announcements on the SVL Yacht Club Facebook page or one of the other community Facebook pages where you can respond.

This is a community event, so if you forget to enter, no worries, we will be judging all homes in the community that are decorated as we drive by.

So start planning your decorations and be a part of the fun.

Association Discount

Get the discount you deserve! Association Discounts are available for your Homeowner's Insurance.

We represent the top insurance companies in the Nation. Allow us to review your current coverage to make sure you are receiving ALL the discounts available to you!



Call us today to speak to one of our knowledgeable insurance agents.

ISU Insurance Services - ARMAC Agency

- Homeowners Insurance
- Auto Insurance
- Boat Insurance
- Watercraft Insurance
- Special Event Liability

17177 Yuma Street
Victorville, CA 92395
Lic. OC26179

Phone: (760) 241-7900
Web: www.isu-armac.com

One Responsible Source™



BEAR VALLEY ANIMAL HOSPITAL

20991 BEAR VALLEY RD ~ APPLE VALLEY, CA 92308

PHONE: (760) 240-5228

CHIEF VETERINARIAN DR. JAIME VELASCO ~ OVER 35 YEARS OF EXPERIENCE



Se habla español

We are a full service animal hospital & offer the following services:

- Puppy & Kitten Wellness Programs
- Laser Therapy • Digital Radiographs
- Digital Dental Radiographs • Ultrasound
- Spay • Neuter • Dental Cleaning
- TPLO Surgeries

We provide our patients experienced care with a gentle touch.

Hours:

Monday - Friday -
7:30am-6pm
Saturday - 8am-4pm
Sunday - Closed

We offer low cost
vaccine clinics:
Thursday from 2-4pm &
Saturday from 9-12pm
Rabies are only \$8.00



\$20 OFF EXAM

OR 20% OFF

Dental Cleaning Packages
Bear Valley Animal Hospital
Expires: 12/01/2020

~Grooming Available ~ 760-240-7828

CARPET CLEANING

CALL PAUL NOW FOR MILITARY & SENIOR DISCOUNT



MENTION THIS FLYER
AND RECEIVE FREE 3M
SCOTCHGARD PROTECTOR

Free
Pet treatment
with minimum

760.403.1587

When you need the Best in Quality & Red Carpet Service!!

"TRUST YOUR CARPET & FURNITURE TO A IICRC CERTIFIED CLEANER"

GOT DIRTY TILE & GROUT?

"We only do quality work guaranteed"



American Tree Co.



CSLB # 927926



Tree Trimming - Tree Removal - Stump Removal - Tree Planting

"The bitterness of poor workmanship lingers long after the lowest bid!"

(760)503-9000

Check us out @ www.americantree.net

Apple Valley, Ca

Liability & Workers Comp Insured

Email: md92307@gmail.com

COMMUNITY events



The Association Office and Community Center have Re-opened.

There will be social distancing limitations in place when visiting our offices to keep everyone safe.

The main entrance to the Community Center will be unlocked, but you will need to check in with Public Safety upon arrival.

This is our first step in reopening for the community. We will continue to monitor San Bernardino County's guidelines

for additional openings of amenities. We are still encouraging everyone to handle business remotely, as much as possible, by calling our office: 760.245.9756 or by email admin@svla.com. Our doors will be open for those needing to speak to someone in person.

As a reminder, the Association office hours are 7:30 a.m. - 6:00 p.m., Tuesday through Friday.

Due to social distancing orders in place, classes, clubs and committees will not be meeting at this time. Please view the SVLA website- www.svla.com -for updates and on how we will be conducting any upcoming meetings. We will also notify you of any changes via social media outlets. Sign up for our email E-Blasts via our website and Like us on Facebook.



Playgrounds Open

Maintenance will be adding the playgrounds - Meadowlark Park, East Beach and Playfair Park - to their sanitizing schedule, but we also encourage residents to be sure to practice safe hand washing and sanitizing to keep everyone safe.

SVL Committees

| COMMITTEES | COMMITTEE CHAIR | MONTHLY | TIME/LOCATION |
|------------------------------|--------------------|---------------------------|------------------|
| Architectural Committee | Karen Hillers | 2nd & 4th Thurs. | 4pm PVR |
| Citation Committee | Don Nelson | 1st Tuesday | 5:00pm PVR |
| Communications Committee | TBD | TBD | |
| Community Plan Committee | TBD | TBD | |
| Community Task Force | | 1st Tuesday & 3rd Tuesday | 5:30pm 5:30pm |
| Equestrian Estates Committee | Cathy Westmoreland | 3rd Tuesday | 6pm EECH1 |
| Finance Committee | Bill Walters | Meetings vary | |
| Lake Committee | Chris Hall | 2nd Thursday | 6:30pm PR |
| YAC Committee | TBD | (Inactive) | |

ASSOCIATION OFFICE HOURS

CLOSED MONDAYS

OPEN TUESDAY THRU FRIDAY 7:30 A.M. - 6:00 P.M.

Boat Test for Vessel Operator's Permit occurs Daily at 9am in PVR
Vessel Operator's Permit **renewals** occur Daily at 7pm in addition to the original 9am slot - (See Public Safety Dispatch)

On line test available at www.svla.com (Public Safety page)

SVL Clubs

| CLUBS | FACILITATOR+ CONTACT |
|-----------------------------------------------|--------------------------------------------------------------------------------------------------------------|
| Amateur Radio Club - 1st TH, 7pm PR | George Ellison NOGWE 760-810-1008, george@4mailservice.com |
| Boy Scouts Troop 2226, 2nd, 3rd 4th M, 6pm PR | C.J. Cook 760-887-6200 |
| Cub Scout Pak 26 , 2nd, 3rd 4th M, 6pm MLH | Britt Imes 760-900-3897 |
| The Coffee Break Club-3rd TH, 10am-12pm MLH | Dennis Verhagen 760-243-2128, dennisverhagen@earthlink.net |
| Lions Club Poker - 1st F, 7pm MLH | Don Nelson 760-964-7552 |
| Rods & Relics Club - 2nd SAT, 8am PVR | Don Sedam 760-955-6052 |
| Social & Fishing Club - Varies, MLH | Robert Eaton 760-951-8721 |
| SVL Pan Group, 2nd & 3rd W, 12pm - 4pm PR | Carol Christie 760-243-1526 |
| Veterans Club - 4th TH, 6-8:30pm PR | Chris Harvey 209-338-7349 |
| Yacht Club - 3rd TH, 6-8pm MLH | Rick Groff 442-242-7095 |

SVL Recreational Classes

| CLASS | DAY | TIME | LOC. | Instructor |
|-----------------------------------------------|-------|-------------------------------|--------|------------------------------|
| Bocceball /Horseshoes | M.W.F | 8 - 11am | MLP | Raul Paz 760-245-6311 |
| Group Exercise (Body Express) | M,W,F | 8 - 9am | MLH | Jace Knisely 760-628-6416 |
| Power Yoga | T/W | 6:30pm-7:30pm | PR/MLH | Jace Knisely 760-628-6416 |
| Line Dance Beginner/Intermediate. | M | 9:10-10:10am 10:10-11:40am | MLH | Su Kim 760-241-8823 |
| Line Dance Ultra Beg./ Beg./Easy Intermediate | T | 8-9am, 9-10am 10-11:30am | MLH | Su Kim 760-241-8823 |
| Arthritis Exercise | T,TH | 8 - 9am | PR | Dottie Schiller 760-243-4697 |

Key for Locations

| Abbreviation | Name/Location of Facility |
|-----------------------|----------------------------------------------------------------------|
| MLH - Meadowlark Hall | Community Building 12975 Rolling Ridge Drive (Great Room) |
| PR - Palm Room | Community Building 12975 Rolling Ridge Drive (Small Room) |
| PVR - Parkview Room | Community Building 12975 Rolling Ridge Drive (Conference Room) |
| EECH1 | Equestrian Estates Clubhouse, 12660 Indian River Drive, Apple Valley |
| MLP | Meadow Lark Park, 12975 Rolling Ridge Drive |
| WB | West Beach, 13230 Country Club Drive |
| EB | East Beach, 13244 Country Club Drive |
| PFP | Playfair Park (Equestrian Estates) |

Puzzles4Kids

by Helene Hovanec

CRISSCROSS – UNITED STATES POSTAL SERVICE

Each word will fit into one spot in the grid. Use the starting letters as a guide and fit each word into its spot. All words will be used, so cross off each one after you put it into the grid.

- 3 Letters
TAG
ZIP
4 Letters
CITY
DATE
SEAL
SHIP
WRAP
5 Letters
ROUTE
STAMP
WRITE
6 Letters
LETTER
PARCEL
PEN PAL
PICK UP
VOLUME
7 Letters
ADDRESS
AIR MAIL
DELIVER
EXPRESS
POSTAGE
SATCHEL

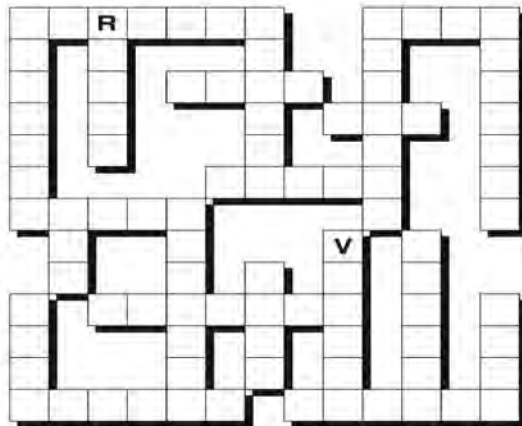

©2020 King Features Syndicate, Inc. All rights reserved.

Even Exchange

by Donna Pettman

Each numbered row contains two clues and two 6-letter answers. The two answers differ from each other by only one letter, which has already been inserted. For example, if you exchange the A from MASTER for an I, you get MISTER. Do not change the order of the letters.

- | | | | |
|---------------------|-----------|----------------------|-----------|
| 1. Gut feeling | ___ N ___ | Starsky's partner | ___ T ___ |
| 2. Gloomy and dull | ___ R ___ | Starry-eyed | ___ M ___ |
| 3. Huge telescope | ___ U ___ | Walk awkwardly | ___ O ___ |
| 4. Circular map | ___ B ___ | Catcher's mitt | ___ V ___ |
| 5. Go away, cat! | ___ M ___ | Leftover food morsel | ___ P ___ |
| 6. Iciness | ___ S ___ | Forward-facing | ___ N ___ |
| 7. Vegetable patch | G ___ | Prison dean | W ___ |
| 8. Provide evidence | ___ V ___ | Writing style | ___ S ___ |
| 9. Leisure pursuit | H ___ | Hotel foyer | L ___ |
| 10. Concoct | ___ V ___ | Bent on | ___ T ___ |

©2020 King Features Synd., Inc.

HOCUS-FOCUS

BY HENRY BOLTOFF

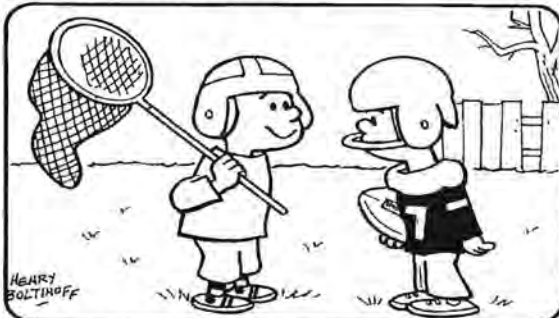

Find at least six differences in details between panels.

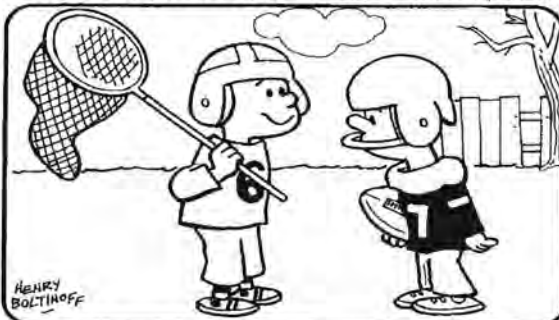

Differences: 1. Cloud is added. 2. Grass is missing. 3. Boy on left is taller. 4. Tree is in front of fence. 5. Nose is larger. 6. Number added to shirt.

A RHYMING RIDDLE!

Pray tell me, ladies,
if you can,
Who is that highly
favored man,
Who, though he has
married many a wife,
May still live single
all his life?

PUZZLE CARD! Can you fathom the Jolly Jester's confusing conundrum?

Answer: A clergyman.

HERE COME THE OLSEN KIDS! Each boy in the Olsen family has as many sisters as brothers. Each sister has half as many sisters as she has brothers. How many brothers and sisters are there on this "Bicycle Built For ..."?

Answer: There are four brothers and three sisters.

FIND-A-WORD! On the top line is our mystery word. You need to fill in the missing letters. Clue words (smaller words contained in letter-by-letter order within the mystery word) are defined below.

- To fix something.
- The very limit.
- A statement of approval.
- Pieces in a board game.

Answers: 1. Mend 2. End 3. Amen 4. Men. Mystery word: Amend

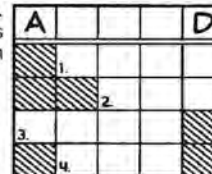

Illustrated by David Coulson

Junior Whirl

by Charles Barry Townsend



KNOW YOUR ALPHABET!

See if you can answer the following questions by using just one, two or three letters from the alphabet. (Each letter must be pronounced separately.)

- What letters spell ...
- a slang expression?
 - a two-digit number?
 - a form of jealousy?
 - a likeness or image?
 - special movie actions?
 - comfort?
 - a poetic lament or song?
 - a hated foe?
 - a rundown neighborhood?
 - to feel great happiness?

Answers: 1. O-G (oh gee). 2. A-T (eighty). 3. N-V (envy). 4. F-E-G (effigy). 5. F-X (effects). 6. E's (ease). 7. L-E-G (leg). 8. N-M-E (enemy). 9. C-D (ceddy). 10. X-T-C (ecstasy).



Kids' Maze Solution

- Even Exchange answers
- Hunch, Hunch
 - Dreamy, Dreamy
 - Hubble, Hubble
 - Globe, Glove
 - Scram, Scrap
 - Invent, Intent
 - Prove, Prose
 - Garden, Warden
 - Frost, Front
 - Hobby, Lobby



Kids' Maze

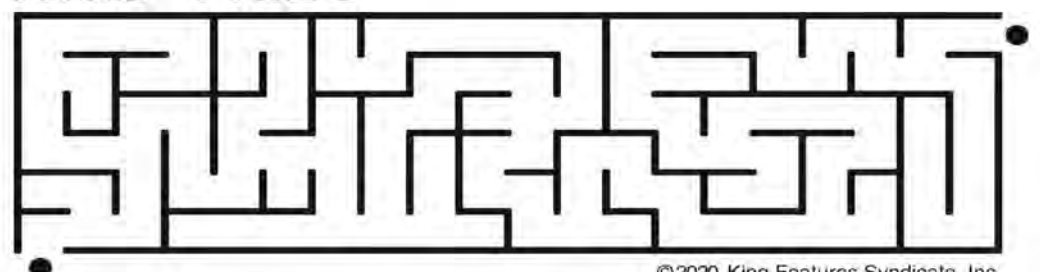

©2020 King Features Syndicate, Inc.



**YOUR AD BELONGS IN
THE SHOPPER NEWS:
A LOCAL ADVERTISING PAPER
IN SILVER LAKES/HELENDALE**

***Advertise your business also in
Silver Lakes/Helendale
(mailed to every PO Box)***

**CALL 760.628.9732
OR EMAIL: LoveMediaGroup@YAHOO.COM**

CONTACT US TODAY!

BUSINESS IN VIEW

Ingle507 Productions



"BECAUSE MEMORIES MATTER"

-SPECIAL EVENTS PHOTOGRAPHY-

- ★ **3 Pose SPECIAL Only \$30!**
*Digital Only
- ★ **Mobile Christmas** Photography
- ★ **GO LIVE** Internet Video Production
- ★ Birthdays
- ★ Retirements
- ★ Graduations...**AND MUCH MORE!**

CALL NOW! 424-800-3175

INGLE507@YAHOO.COM

[YOUTUBE/INGLE507](https://www.youtube.com/channel/UCIngle507)

DAVE'S MOBILE MARINE REPAIR

Dave Mazzaresse
Owner
mazz75@msn.com



WWW.DAVESMOBILEMARINEREPAIR.COM

Apple Valley, CA 92307 | 760.987.0846

BUSINESS LIC #009439 - INSURED

ArchAngel

ESTATE PLANNING AND TRUST SERVICES

VICTORIA P. MARTIN

Attorney at Law

Office: (760) 946-2233 • Fax: (760) 946-2277

16191 Kamana Rd., Suite 202 • Apple Valley, CA 92307

vmartin@archangeltrust.com • www.archangeltrust.com

CARPET CLEANING

CALL PAUL NOW FOR MILITARY & SENIOR DISCOUNT

STEAMPRO.COM 760-403-1587



MENTION THIS FLYER
AND RECEIVE FREE 3M
SCOTCHGARD PROTECTANT

Free
Pet treatment
with minimum

760.403.1587

When you need the Best in Quality & Red Carpet Service!!

"TRUST YOUR CARPET & FURNITURE TO A IICRC CERTIFIED CLEANER"

GOT DIRTY TILE & GROUT?

Hesperia Mobile Notary Christina Price

**Certified Loan Signing Agent
& Mobile Notary Public**

Cell # 760-792-5231

[christinapricenotary.wix.com/
hesperia-notary](http://christinapricenotary.wix.com/hesperia-notary)

Serving The High Desert Since 2005



Absolute Lashes

EYELASH EXTENSIONS

DIANADAVIDSON@VERIZON.NET | 760.221.8807
8441 ROOSEVELT CT., HESPERIA/OAK HILLS, CA 92344



**the SVLA
BREEZE**
YOUR SPRING VALLEY LAKE ASSOCIATION'S OFFICIAL MONTHLY NEWSPAPER FOR THE JEWEL OF THE HIGH DESERT

ADS 760-628-9732

*****ECRWSSSEDDM****

Postal Customer

PRST STD
US POSTAGE
PAID
Victorville, CA
PERMIT 5683

OPEN ENROLLMENT AT BCC BEGINS NOVEMBER 18TH!

**SPRING
2021
@ BCC**
WWW.BARSTOW.EDU

**FULLY
ONLINE
CLASSES**

**LOW TO
NO COST
ENROLLMENT**

**LAPTOPS
HOTSPOTS
FREE
WI-FI**

**WEEKLY
FOOD
PANTRY!**

**CONTACT BCC TODAY, OUR
STAFF IS HERE TO HELP
ELEVATE YOUR STORY!
760-252-6769**

